

RESTORED CORNER FOR STATE OF OREGON - DEPARTMENT OF FORESTRY

One quarter corner common to Sections 11 and 14, T3N, R10W, W.M., Tillamook County, Oregon.

ORIGINAL by C.J. Handley, August 30, 1873.

40" Hemlock corner tree; now a 56"x6ft. high stump with rotted face on North side.

RESTORATION by Richard A. Morris, LS401, April 16, 1963.

Rescribed corner tree, 1/4S11 on North face and 1/4S14 on South face; scribe S visible on partially open face on South side, face rotted out on North side from which a:

7" Cedar bears N11°W 65.7 ft.; now 16" with face closed, bears N09°W 66.5 ft.

5" Hemlock bears S72 1/2°E 21.3 ft.; missing.

RESTORED

Var. 21 1/2°E

Set 5/8"x36" steel re-bar with yellow plastic cap marked "LS 1998", 34 inches into center of stump, and from which a:

25" Fir bears S07 1/2°W 57.9 ft. to face; scribed 1/4S14BT.

Oregon State Forestry Department metal location poster on new BT. Also poster on 16" Cedar BT.

Dated January 8, 1987.

Restored by

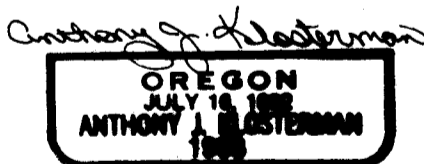
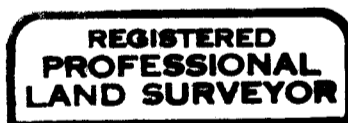

Present and witnessed by David B. Buchholz  
Clifford R. Foster

